



B180K

MODEL: B180K

1-Piece Ball Valve

Reduce Port 1000 WOG

PRODUCT FEATURES

- One-Piece Ball Valve
- Manufacture & Tested to MSS SP-110, API 598
- Various Thread Types Available (NPT, BSP, & Etc.)
- For General Purpose Industrial And Chemical Applications
- Adjustable Stem Packing With Blow-Out Proof Stem

SPECIFICATION

- Investment Casting Valve Body
- Pressure Rating: 1000 PSI WOG
- Size Available: 1/4 to 2"
- Shell 1500 PSI Water 100 PSI Air
- Seat 1100 PSI Water 100 PSI Air



Keeping Safe
with safe Valves

KJV valves offer positive solutions for all your flow-control applications



B180K

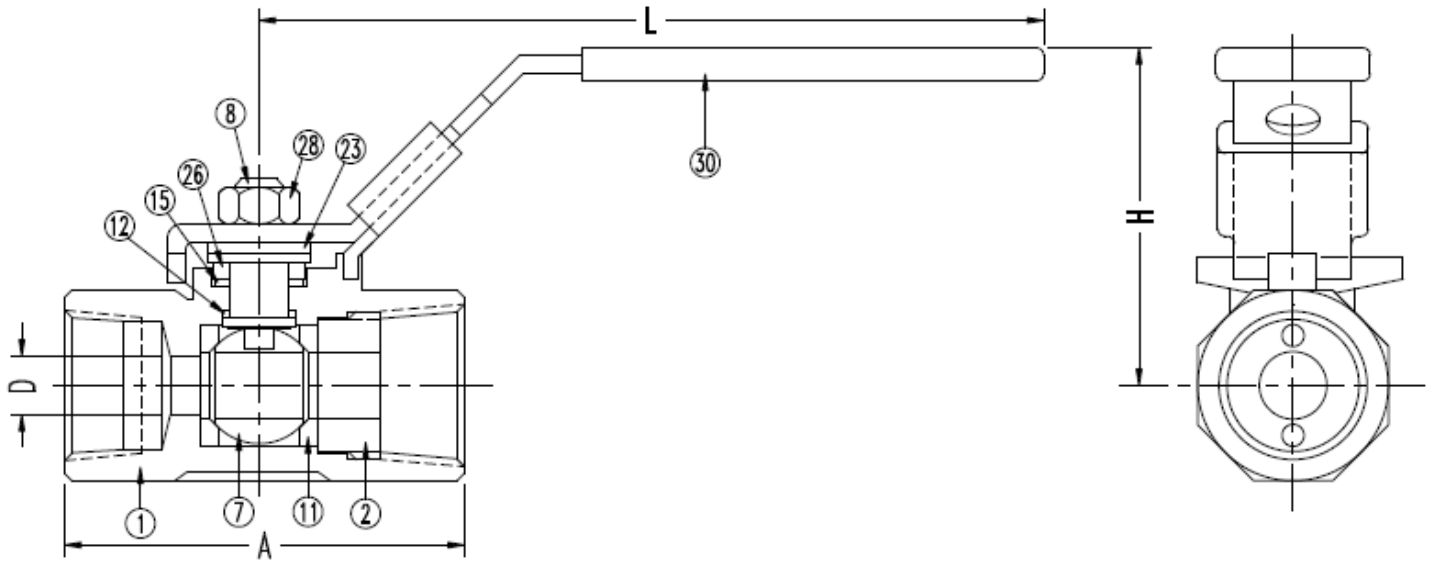

MATERIAL LIST

ITEM	Q'TY	PART NAME	B180K-1	B180K-3
1	1	BODY	A351 CF8M	A216 WCB
2	1	SPACER	A351 CF8M	12L14/1045
7	1	BALL	A351 CF8M	
8	1	STEM	SS 316	
11	2	SEAT	TFE/RTFE	
12	1	STEM SEAL	TFE/RTFE	
15	1	STEM PACKING	TFE	
23	2	BELL WASHER	W1-8 CS(SK5)	
26	1	GLAND	SS 304	
28	1	LOCK NUT	SS 304	CS A283
30	1	HANDLE	SS 304	CS A283

DIMENSIONS

IN/MM

NPS DN	A	D	H	L
1/4"	2.15	0.35	1.97	4.25
8	54.50	9.00	50.00	108.00
3/8"	2.15	0.35	1.97	4.25
10	54.50	9.00	50.00	108.00
1/2"	5.00	0.35	1.97	4.25
15	127.00	9.00	50.00	108.00
3/4"	5.00	0.47	2.05	4.25
20	127.00	12.00	52.00	108.00
1"	2.93	0.62	2.32	5.79
25	74.50	15.90	59.00	147.00
1-1/4"	3.15	0.81	2.52	5.79
32	80.00	20.60	64.00	147.00
1-1/2"	3.48	1.00	3.15	7.56
40	88.50	25.40	80.00	192.00
2"	3.94	1.25	3.31	7.56
50	100.00	31.80	84.00	192.00



Kong Jih Valve Industrial Co., Ltd

Tel: +886-4-2681 3379
 Fax: +886-4-2682 1368
 E-mail: marketing@ksvalve.com